



Pippin Road, , CM5

BUTLER & STAG



**Guide Price £550,000 - £575,000**

**Situated within this contemporary style development which was constructed within the last few years, is this stunning three-bedroom semi-detached house situated in the heart of Ongar High Street.**



## Freehold

- Semi Detached Family Home
- Three Bedrooms/Two Bathrooms
- Open Plan Kitchen/Dining/Lounge Area
- Spacious Garage
- South East Facing Garden
- Off Street Parking

With flexible living space, this property comprises a spacious open-plan kitchen/dining/lounge area with access to the well-presented garden, and a downstairs WC.

The first floor provides three bedrooms and a family bathroom, the master having the luxury of an en-suite.

Externally to the rear you will find a 40' private rear garden which is perfect for entertaining, and a driveway for numerous cars, also the added bonus of a spacious garage which can be used for a number of things.

Pippen Road occupies a wonderful location positioned in the picturesque village of Ongar. There are good local shopping facilities available in Ongar with more comprehensive shopping in the town of Epping. The area has an excellent choice of well-regarded state and private schools.





## Pippin Road, CM5

Approx. Gross Internal Area 848 Sq Ft - 78.78 Sq M  
Approx. Gross Garage Area 161 Sq Ft - 14.96 Sq M  
Approx. Gross Total Area 1009 Sq Ft - 93.74 Sq M

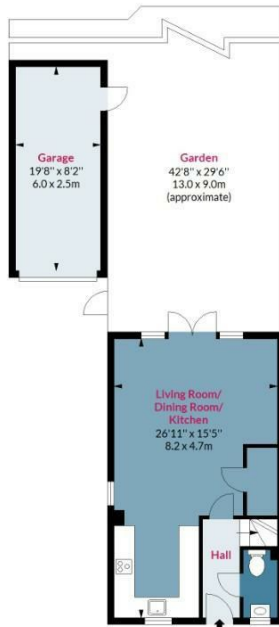

**Ground Floor**

Floor Area 424 Sq Ft - 39.39 Sq M

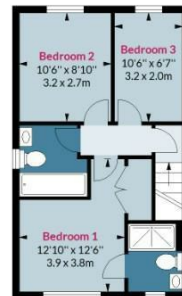

**First Floor**

Floor Area 424 Sq Ft - 39.39 Sq M



**BUTLER & STAG**



Measured according to RICS IPMS2. Floor plan is for illustrative purposes only and is not to scale. Every attempt has been made to ensure the accuracy of the floor plan shown, however all measurements, fixtures, fittings and data shown are an approximate interpretation for illustrative purposes only. 1 sq m = 10.76 sq feet.

lpaplus.com

Date: 7/02/2023

**BUTLER & STAG**

☎ 01992 667666

🏠 4 Forest Drive, Theydon Bois, Essex, CM16 7EY

✉ theydon@butlerandstag.com

[www.butlerandstag.uk](http://www.butlerandstag.uk)

IMPORTANT NOTICE - These particulars have been prepared in good faith and they are not intended to constitute part of an offer or contract. We have not performed a structural survey on this property and the services, appliances and specific fittings have not been tested. All photographs, measurements, floor plans and distances referred to are given as a guide and should not be relied upon.